



Atlanta State Park Trails Map

927 Park Rd 42
Atlanta, TX 75551
(903) 796-6476
www.texasstateparks.org

LEGEND

- Headquarters
- Parking
- Restrooms
- Day Use Area
- Swimming Area
- Amphitheater
- Group Picnic Pavilion
- Boat Ramp

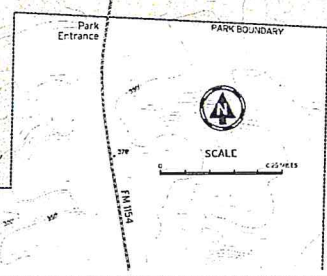
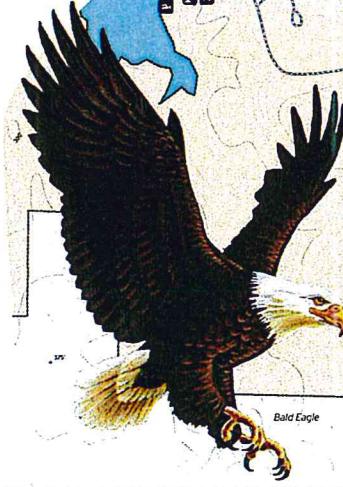

POINTS OF INTEREST

(GPS coordinates shown in degrees, minute

- 1 WHO TRAVELED HERE?**
33° 13' 51.8" N 94° 14' 59.0" W
Remnants of an old road, or wagon trace, leads to near where Samuel Bobo operated a ferry across Sulphur River. Over 100 years before the construction of Wright Patman Lake, wagon and horse traffic would have crossed into ruts like this to more than 3 feet deep.
- 2 SUNSETS, SOARING, AND SQUADRONS**
33° 14' 19.1" N 94° 15' 23.4" W
Take in this breathtaking view of the 27,025 acre Wright Patman Lake. You may see soaring Bald eagles and a squadron of White Pelicans fishing for a meal.
- 3 FARMERS CONSERVING THE LAND**
33° 13' 53.6" N 94° 14' 23.6" W
Cass County land was used for agricultural crops. Corp of Engineers began lake development in the 1950s. Farmers built terraces to conserve soil and water. Hike the trail, notice the remnants of the oldest known terraces in the state of Texas.
- 4 A PEACEFUL PLACE**
33° 13' 53.0" N 94° 13' 56.7" W
Bring a book, a picnic, and escape the hustle and bustle of life at this bluff overlooking Wilkins Creek cove. You can catch a glimpse of a variety of wildlife.
- 5 A CHANGING VIEW**
33° 14' 08.83" N 94° 14' 0.995" W
Once dominated by thick forest, many trees were lost to hurricane and drought. Now there is a gorge overlooking the lake.

All trails hiking and biking unless otherwise noted.
Contour intervals are 10 feet. Trail lengths are in miles.
Elevation levels are in feet. Map compiled by Texas State Parks and Wildlife Department.

In accordance with Texas State Depository Law, this publication is available at all Public Libraries throughout the State of Texas. © 2011 Texas Parks and Wildlife Department PWD MP P-1508-00271